

Professional Digital Two-Way Radio System

# MOTOTRBO™

## Remote Mount Control Head

Installation Guide



EN



**MOTOROLA SOLUTIONS**

radiotronics 



**PMLN5404**

# Remote Mount Control Head Installation

 <p><b>Caution</b></p>	<p>The radio must be disconnected from the power supply before commencing any disassembly.</p> <p>The Radio Installation Manual should be referred to for more detailed information on warning and safety.</p>
---	--

**Note:** Firmware version R01.04.00 or later **MUST** be programmed into the radio for proper operation of the Remote Mount Control Head configuration.

## To Disassemble the Control Head from the Radio

1. Insert the dismantling tool in the groove between the control head and the radio assembly.
2. Press the dismantling tool under the control head to release the snap features.
3. Separate the control head and the radio by removing flex cable from radio assembly.

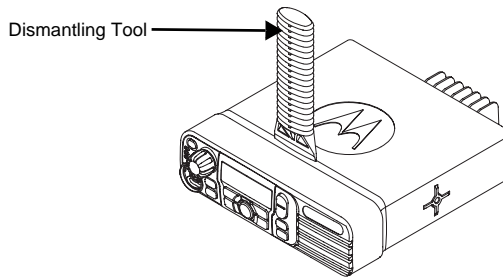

Figure 1 Control Head Removal

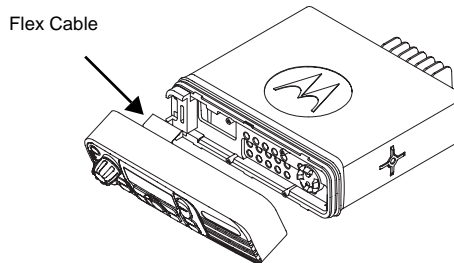

Figure 2 Flexible Connection Removal

### **To Assemble the Remote Control Head Interface Module on the Control Head**

1. Verify that the flex cable is fully seated in the connector on the control head assembly.  
(See Figure 3).
2. Assemble the flex cable to flex connector on the remote control head interface module, making sure it is fully seated. (See Figure 3).
3. Press the control head onto the remote control head interface housing until ALL the tabs snap into place.
4. Verify that the control head seal is not pinched and visible. If a pinch is found, disassemble the control head, reseal the O-ring and reassemble the control head.

### **To Assemble the Remote Radio Interface Module on the Radio**

1. Verify that the flex cable is fully seated in connector on the remote radio interface module.  
(See Figure 3).
2. Assemble the flex cable to the flex connector in the radio assembly, making sure it is fully seated.  
(See Figure 3).
3. Press the remote radio interface housing onto the radio chassis until ALL the tabs snap into place.

### **To Install the Remote Control Head**

1. Position the remote trunnion bracket in the desired location for remote control head.
2. Using the trunnion bracket as a template, mark the positions of the holes on the mounting surface.
3. Center punch the marked spots and realign the trunnion in position.
4. Secure the trunnion bracket with the self drilling provided screws.
5. Route two remote cables as required.
6. Assemble the 10 pin connector by aligning the pins and push the plug onto the receptacle at rear of the control head. Twist outer collar clockwise to lock into place.
7. Assemble the 25 pin connector by aligning the pins and mounting holes. Secure the connector with two screws provided.
8. Snap the remote control head assembly into trunnion bracket.
9. Adjust the remote control head assembly as required and secure it with the two wing screws provided.

### **To Install the Mobile Radio**

1. The Radio Installation Manual should be referred to for detailed radio installation steps.

**Note:** Remote cable connection on the radio side is the same as the remote control head side.

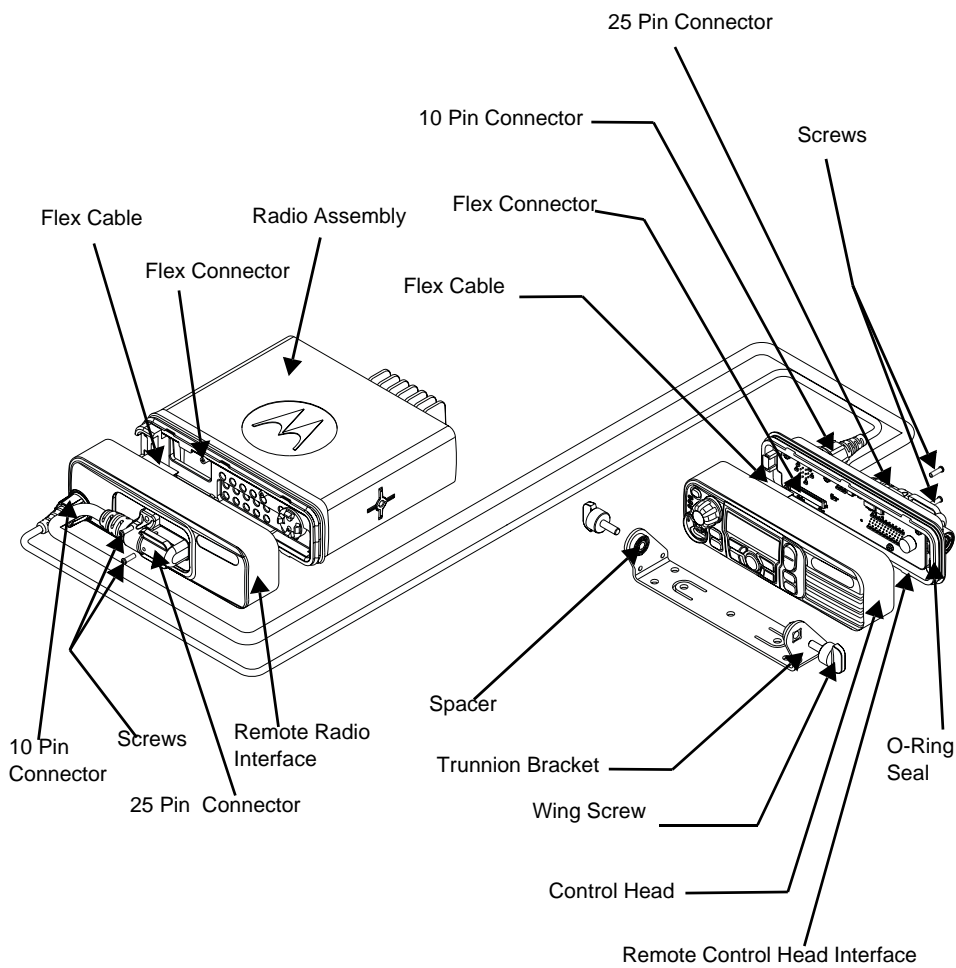

Figure 3 Remote Control Head Assembly and Trunnion Mounting

# Replacement Components

Click on each component to go to the relevant page on our website.

Item	Part Number	Description
1	PMLN5403_	Remote Control Head Interface
2	PMLN5405_	Remote Transceiver Interface
3	3015638H01	Flat Flex Cable
4	3216200H01	Control Head O-Ring
5	PMKN4074_*	3 Meter 10 Pin Extension Cable
		3 Meter 25 Pin Extension Cable
6	PMKN4073_*	5 Meter 10 Pin Extension Cable
		5 Meter 25 Pin Extension Cable
7	03012000001	Screw
8	PMLN4912_	Remote Trunnion Kit
9	0371950L01	Self Drilling Screw
10	0371815L01	Wing Screw
11	4371571M01	Spacer
12	6686119B01	Dismantling tool

\* Cable kits to be ordered separately and are not included with the PMLN5404

**Note:** Specifications are subject to change without notice.